

Gigaset

L410

Congratulations

By purchasing a Gigaset, you have chosen a brand that is fully committed to sustainability. This product's packaging is eco-friendly!

To learn more, visit www.gigaset.com.



GIGASET. INSPIRING CONVERSATION.
MADE IN GERMANY

Gigaset L410 – Freedom of movement while phoning

Using the practical handsfree clip you can speak on the telephone for hours in comfort – with outstanding sound quality. Your Gigaset L410 expands the possibilities of your cordless telephone:

Enjoy full freedom of movement while phoning

Attach the Gigaset L410 to your clothing and move around as you wish while phoning. You can then be reached anywhere at home or in the office and keep your hands free while phoning – without any annoying cables.

Operate the device at the touch of a button

Are you moving around the house and want to take an incoming call? Or do you want to transfer a call on a handset to your handsfree clip? All you need to do is press one key and you'll be connected with the caller.

Hold a three-way conference

A family member is making a call and you would like to participate. Simply join in on the existing call and talk on the telephone together.

Adjust the volume of the Gigaset L410 to your surroundings

Regulate the volume of the loudspeaker and ringtone by simply pressing a key – five volume levels are available. You can also switch off the ringtone completely.

Environment

Environmentally-aware telephone calls – Gigaset Green Home. You can find details on our ECO DECT products at www.gigaset.com/service

Further information is available online at www.gigaset.com/gigasetl410.

Please register your Gigaset device immediately after purchase, at www.gigaset.com/service – this will enable us to help you more quickly if you have any questions or need to make a claim on the guarantee!

Have lots of fun with your new handsfree clip!

Overview



1 Loudspeaker

2 Volume keys /

Setting the volume of the loudspeaker and the ringtone. → page 11

3 Answer/End call key

Press briefly:

Accept call, take over call*, end call → page 7

Hold down:

Join in on a call → page 9

Hold for more than 3 seconds:

Switch device on/off → page 10

4 Light indicator (LED)

5 Microphone

6 Charging connection

*For example, this function is available on the following telephones: Gigaset C610/C610A, Gigaset S810/S810A and Gigaset SL400/SL400A (see also www.gigaset.com/compatibility).

Light indicator (LED)

Prior to registration

Green flashing 3 x per second Ready to register

After registration

Green flashing every 5 seconds Registered and on stand-by

Red flashing every 5 seconds Battery charge low

Red lit continuously Battery is charging

Green lit continuously Battery is fully charged (device in the charging cradle)

Operating mode display

Green flashing long, 1 x per second Incoming call

Green flashing long, every 5 seconds Ongoing call

Red flashing 1 x per second Registered, but outside the range of your base

Safety precautions

Warning

Read the safety precautions and the user guide before use.
Explain their content and the potential hazards associated with using the telephone to your children.



Use only **rechargeable batteries** that correspond to the **specification provided** on page 21, as this could otherwise result in significant health risks and personal injury.

At the end of the battery's life, the technology will cause the battery to thicken and it may develop a convex curve. In this case, the device will no longer function perfectly. If this occurs, please replace the battery with an original replacement battery (Gigaset V30145-K1310-X448) and dispose of the old battery. Always handle the battery with care, do not damage the casing with sharp objects and do not exert any great pressure on the battery.



Using your telephone may affect nearby medical equipment. Be aware of the technical conditions in your particular environment, e.g., doctor's surgery. If you use a medical device (e.g. a pacemaker), please contact the device manufacturer. They will be able to advise you regarding the susceptibility of the device to external sources of high frequency energy. Please refer to the Appendix chapter for the specifications of this Gigaset product.



Do not hold the handset to your ear, as doing so could result in serious, lasting hearing damage. Your Gigaset is compatible with the majority of digital hearing aids on the market. However, we cannot guarantee that the device will function perfectly with every hearing aid.

The handset may cause disruptive noises (humming or whistling) in analogue hearing aids, or override these. Please contact your hearing aid technician in the event of problems.



Do not install the charger in bathrooms or shower rooms. The device is not splashproof.



Do not use the phone in environments with a potential explosion hazard, e.g., paint shops.



If you give your phone to a third party, make sure you also give them the user guide.



Remove faulty devices from use or have them repaired by our Service team, as they could interfere with other wireless services.

The Gigaset L410

Gigaset L410 is a handsfree clip for cordless telephones. You attach it to your clothing in order to enjoy complete freedom of movement while on the telephone. The Gigaset L410 is registered to a Gigaset base or a DECT base from another manufacturer. Depending on your base, you can register multiple Gigaset L410 and use them to make internal, external or conference calls.

Prerequisite: Any base from a different manufacturer must be GAP-compatible (see enclosed documentation). GAP (Generic Access Profile) is a standard for the interoperation of handsets and bases from different manufacturers. Information on the range of functions available on various telephones can be found in the section Compatibility (→ page 22).

Getting started

Check the contents of the package

- ◆ Gigaset L410
- ◆ Battery
- ◆ Battery cover with clip
- ◆ Charging cradle with mains plug
- ◆ These instructions for use

Setting up the Gigaset L410

Insert battery

- ▶ Plug the battery connector into the bottom right socket in the casing (see arrow).

The **red** cable on the connector is located on the side of the casing marked with +, the **black cable** on the side marked with -.



- ▶ Place the battery into the casing.

The foam cushion on the battery must face **upwards**. Please ensure that the cables lie between the battery and the casing and not under the battery.



Closing the battery cover

- ▶ Insert the cover at the bottom end of the casing.
- ▶ Close the cover and apply pressure until it locks into place.

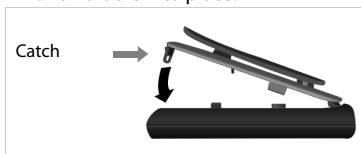

To open the cover again:

- ▶ Loosen the catch and lift the cover upwards.

Registering the device with the base

In order to telephone using your Gigaset L410, it must be registered with your telephone's base. If you purchased the device in a set with a Gigaset telephone, it is already registered.

Note

The Gigaset L410 uses 0000 as its PIN for registration. When you have set another PIN on your base, you must reset this to 0000 to enable registration of the L410. After registration you can change the PIN again.

As soon as you have **inserted the battery**, the device **becomes ready for registration for a 5 minute period**. The LED indicates readiness for registration by flashing (green, 3 x per second).

Following this, the device switches off. When you switch the device on again (by pressing the answer/end call key for at least 3 seconds) it is ready for registration again.

- ▶ For registration, stand close to your telephone's base.
- ▶ Start the registration process with the base as described in your base's operating instructions (on most DECT telephones by holding down the paging key); the base will take up to one minute to complete registration.

Device successfully registered

- ◆ The LED flashes (green, every 5 seconds) and one confirmation tone is emitted (sequence of tones rising in pitch).
- ◆ The device is shown in the internal list of handsets registered to the base.

On telephones that support the full range of functions (→ page 22): with the name **L410**. If more than one Gigaset L410 is registered, a number is appended to the name (**L410-2**, **L410-3**, etc.).

On other telephones: with the internal device name (e.g. **INT 1**, **INT 2**, etc.)

Registration failed

- ◆ A negative confirmation tone is emitted (sequence of tones falling in pitch).
- ◆ If the device cannot be registered within 5 minutes, it switches off.

If the registration was not successful, try again.

- ▶ If necessary, switch on the device again. It is immediately ready for registration.
- ▶ Check whether the registration PIN on the base is set to 0000.
- ▶ Move closer to the base with the Gigaset L410.
- ▶ If the device is already registered to another base, you must de-register it (→ page 10). Following this, it will be ready for registration again.

Securing the clip

- ▶ Attach the Gigaset L410 to your clothing using the clip.

Optimal distance from your mouth: 20 cm



Charging the battery

When delivered, the battery is partly charged. When the device is registered and on stand-by, the charge status is shown as follows:

Device	Battery status	LED
In the charging cradle	Fully charged	Steady green light.
	Charging	Steady red light.
Not in the charging cradle	Sufficient charge	Flashes green, every 5 seconds
	Almost empty	Flashes red, every 5 seconds

In all other operating conditions, (→ page 2) the charge status is not displayed by means of the LED.

When the battery is almost empty, a signal tone is always emitted, 1 x per min.

To charge the battery:

- ▶ Connect the charging cradle to the mains power and place the device in the charging cradle.

It will be fully charged within **2.5 hours**. You can interrupt the charging procedure.

Note: If you place the device in the charging cradle during a call, this will not disconnect the call.

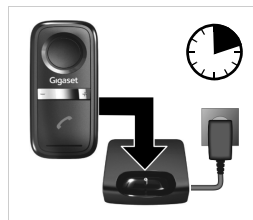

Phoning

With your Gigaset L410 you can accept calls, take over calls or join in on a call. You can call the Gigaset L410 internally from a handset, call back internally, or connect a call.

Accepting a call

An incoming call is indicated by a ringtone and an LED light.

- ▶ Press Answer/End call key.



Ending a call

- ▶ Press Answer/End call key.

Making a call/taking over a call

In order to start an external call, dial the telephone number on the handset.

You can take over the call on the Gigaset L410 as soon as you have started dialling or when the connection is established.

- ▶ Press Answer/End call key.



For example, this function is available on the following telephones: Gigaset C610/C610A, Gigaset S810/S810A and Gigaset SL400/SL400A (see also www.gigaset.com/compatibility).

Note

On other telephones, you must transfer the call from the handset to the Gigaset L410.

- Handset:
- ▶ Call the Gigaset L410 on an internal line (with Gigaset telephones, press the Int key to do so, where necessary, select the Gigaset L410 from the list of handsets registered, press Answer call key).
 - ▶ End the external call by pressing the End call key.
- Gigaset L410:
- ▶ Press the Answer/End call key to take over the call.

Transferring a call from the Gigaset L410

You are making a call using the Gigaset L410 and wish to continue the call on the handset.

- ▶ Press the display key **Yes** on the handset.

Note: If you select **No** and then do wish to transfer the call at a later point, use the **“Listening In”** function described below.



For example, this function is available on the following telephones:
Gigaset C610/C610A, Gigaset S810/S810A and Gigaset SL400/SL400A
(see also www.gigaset.com/compatibility).

Note

Alternatively, you can use the **“Listening In”** function if your telephone supports this and you have switched on the function:

- Handset: ▶ **Hold down** the Answer call key.
- Gigaset L410: ▶ End the call

Acoustic feedback (whistling noise) may occur when the handset and Gigaset L410 are connected to a call at the same time.

Telephones that do not support the **“Listening In”** function (e. g. ISDN or IP-telephones), or telephones on which this function is switched off, cannot transfer calls.

Conference calls

A call is being held on the **handset** or on the **Gigaset L410**. You would like to participate in the call with (another) Gigaset L410.

- ▶ **Hold down** the Answer/End call key on the Gigaset L410 (until you hear a short signal tone).

A call is being held on the **Gigaset L410**. You would like to participate in the call using the handset.

- ▶ **Hold down** the Answer call key on the handset.



This applies to telephones that support the “Listening In” function. If necessary, switch this function on.

Note

On telephones without the “Listening In” function (e. g. ISDN or IP telephones), or if the function is switched off:

- | | |
|---|--|
| Handset:
<small>(is in an external call)</small> | ▶ Call the Gigaset L410 on an internal line (with Gigaset telephones, press the Int key to do so, where necessary, select the Gigaset L410 from the list of handsets registered, press Answer call key). |
| Gigaset L410: | ▶ Accept the call. |
| Handset: | ▶ Start the conference call as described in the operating instructions for the handset. |

All participants hear a signal tone when a participant joins or leaves the conference call.

Note

Acoustic feedback (whistling noise) may occur when you are phoning in the same room with a Gigaset L410 and a handset in handsfree mode. In this case, end the handsfree mode on the handset or increase the distance between the devices.

Operating the device

Switching on

- ▶ Press the Answer/End call key for at least 3 seconds until you hear the start-up melody.

Note: When you place a device that is switched off into the charging cradle, it switches on automatically after a maximum of 1 minute.

Switching off

- ▶ Press the Answer/End call key for at least 3 seconds until you hear the shut-down melody.



Searching for the device

- ▶ Select the Gigaset L410 from the list of registered handsets and call it internally or
- ▶ Use your base's paging function.

Deregistering the device from the base

Using your telephone's handset

- ▶ Carry out the standard deregistration procedure for handsets, as described in the operating instructions for the handset.

Deregistering the device from the base and restoring factory settings

- ▶ Switch off the device (→ page 10).
- ▶ Press the Answer/End call key and one of the volume keys (**-** or **+**) simultaneously for at least 3 seconds.

In this case, the device remains in the list of handsets registered to the base until it is also deregistered there.

Note



Following deregistration, the device automatically switches to registration mode.

Changing ringtone and loudspeaker volume

There are two ringtones, one for external and one for internal calls.

5 volume levels are available for the ringtones and loudspeaker. When you reach the highest or lowest volume level you will hear a signal tone.

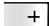
Setting the ringtone volume:

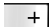
Ringtone quieter		Press briefly		Ringtone louder
Ringtone off		Hold down		Ringtone on

If you do not hear a ringtone when setting the volume, the ringtone is switched off.

Change loudspeaker volume (during a call);

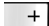
Loudspeaker quieter		Press briefly		Loudspeaker louder
---------------------	---	---------------	---	--------------------

Customer Service & Assistance

Do you have any questions? As a Gigaset customer, you can find help quickly in this User Manual and in the service section of our Gigaset online portal www.gigaset.com/service.

In our constantly updated online service you can find:

- ◆ Extensive information about our products
- ◆ FAQ compilations
- ◆ Keyword search to help find topics quickly
- ◆ Compatibility database: Find out which base stations and handsets can be combined.
- ◆ Product comparison: Compare the features of several products with each other.
- ◆ Downloads for user manuals and current software updates
- ◆ E-mail contact form for customer service

Please register your phone online right after purchase.

This enables us to provide you with even better service regarding questions or an after sales query/issue/claim. In order to contact our customer service via email, please use the email contact form from our Gigaset online portal after selecting your home country.

Our representatives are also available on the telephone hotlines for consultation.

Customer Service & Assistance

Australia	1300 780 878	verso la rete di altri operatori fissi o mobili consultate le tariffe del vostro operatore)	
Austria	0043 1 311 3046	Jordan	00962 6 5625460/1/2
Bahrain	97 31 73 11 173	Kuwait	+965 -22458737/22458738
Belgium	0 78 15 66 79	Lebanon	+9611240259/
Bosnia Herzegovina	033 276 649	+9611236110
Brazil	4003 3020	Luxembourg	+352 8002 3811
(grandes cidades e regiões metropolitanas - Custos de uma ligação local)		Malaysia	+603-8076 9696
.....	0800 888 3020	Malta	+390 2360 46789 (0,10 €)
(demais localidades - Gratuito)		Mexico	
Bulgaria	+359 2 9710666	..	01800 999 4442738 (01800 999 GIGASET)
(0,50 евро на минута от всички държави за стационарни телефони. За обаждания от мобилни телефони може да има други цени).		Netherlands	0900-3333102
Canada	1-866 247-8758	(0,25 € per minuut (vast net). Voor oproepen uit het mobiele netwerk kunnen andere prijzen gelden.)	
China	0 21 400 670 6007 (RMB 0.11)	New Zealand	0800 780 878
Croatia	01 2456 555 (0,23 Kn)	Norway	22 70 84 00
Czech Republic	0 233 032 727	(Oppstartskost 89 øre + 15 øre pr minutt fra fasttelefon. For samtaler fra mobil vil det gjelde egne priser.)	
Denmark	+45 (0) 35 25 86 00	Oman	+968 709281 Ext. 49/21/75
Finland	09 231 134 25	Poland	801 140 160
France	+33 170 706 181	Portugal	(351) 808 781 223
Coût d'un appel local depuis une ligne fixe France Télécom.		(custo de uma chamada local)	
Germany	01805 333 222	Qatar	00974 4257777 / 00974 4257844
Der Anruf kostet Sie aus den deutschen Festnetzen 0,14 € pro Minute. Anrufe aus den deutschen Mobilfunknetzen kosten höchstens 0,42 € pro Minute.		Romania	+40 021 204 9130
Greece	801-100.0.500	Russia	8 (495) 2281312
(Χρέωση 0,0026 € το λεπτό για το σταθερό δίκτυο της Ελλάδας. Για κλήσεις από κινητό ίσως ισχύουν άλλες χρεώσεις)		Saudi Arabia	00966 2 6500282 Ext. 209
Hong Kong	2763 0203	Serbia	0800 222 111
.....	2389 7285	Singapore	6735 9100
Hungary	01 267 21 09 (27 Ft)	Slovak Republic	02 59 68 22 66 (4,428 sk)
India	Please refer to your local warranty card	Slovenija	01 5644171
Indonesia	(62-21) 5673813	South Africa	+2711 46 13 181
.....	(62-21) 888856000	Spain	902 103935
Ireland	18 50 77 72 77	Sweden	87 50 99 11
Italy	199.15.11.15	Switzerland	0848 212 000
(€ cent 8,36 + IVA al minuto da telefono fisso della rete Telecom Italia senza scatto alla risposta mentre per le chiamate effettuate attra-		Taiwan	02 266 24343
		Turkey	0216 459 98 59
		Ukraine	+380-44-451-71-72
		United Arab Emirates	+97144458255/
		+97144458254
		United Kingdom	0 84 53 67 08 12
		USA	1-866 247-8758
		Vietnam	1900 545 416

Please have your record of purchase ready when calling. After sales service is not offered in countries where our product is not sold by authorised dealers.

Manufacturer warranty (Middle East)

On the purchase of your new Gigaset product, we guarantee that this equipment is a genuine manufacturer's product and extend the following warranty:

We guarantee this product against manufacturing defects for two full years from the date of purchase, unless specified otherwise.

Adaptors and batteries for cordless phones carry 6 months warranty from the date of purchase.

Gigaset Communications authorized Service Centres will replace or repair, if necessary, any defective part/parts free of charge by presenting this certificate of warranty at the Service Centre mentioned overleaf.

This Certificate of warranty does not apply if the telephone has:

1. Been misused, mishandled, willfully damaged, neglected, damaged by lightning, improperly repaired, tested, altered improperly in any way.
2. A defect arising out of any failure to follow instructions either in the manual or product specification.
3. In case repairs are carried out of by unauthorized personnel or unauthorized source warranty will be void.
4. A defect arising from using non-Gigaset approved accessories or ancillary items attached to or in connection with the telephone.
5. If this certificate of warranty is not signed and stamped by the authorised distributor.
6. Any other claim resulting out of or in connection with the device shall be excluded from this warranty.

For Southern Africa:

In the event of an after-sales issue/warranty claim please refer back to your point of purchase.

Proof of purchase (receipt) has to be submitted.

Certificate of warranty (Middle East)

The warranty is not valid if it is not signed and stamped by the authorized distributor.

Please fill in the following details and stamp the card to validate the warranty.
All details must be filled in by the dealer and retained by the customer.
This warranty shall apply to products purchased in the Middle East only.

Customer's Name: _____

Product / Model: _____

Dealer's Name: _____

Date of Purchase: _____

Invoice / Cash Memo Details: _____

Dealer's Stamp

Service Centres (Midde East)

UAE

Customer Service Hotline UAE

TEL: 00971-4-4458255 / 00971-4-4458254

Service Collection Point

www.technocare-prodigy.com

KARAMA

Sea Shell Electronics

Opp. Karama Centre

Dubai, UAE

Tel: 00971-4-3979228

Fax: 00971-4-3966205

Deira

Souvenir Mobiles,

Omar Bin Katab Road,

Oppst. Gulf Peral hotel (Tahir Hotel)

Al Baraha Street,

Tel: 00971-4-2731910 / 00971-4-2737377

Sharajah

Hotline Telecom

Sahara Centre

Sharjah, UAE

Tel: 00971-6-5312126

Al Ain

Phone Station

Al Ain Mall, Town Centre,

Tel: 00971-3-7515588

Fujairah

Al Manzil,

Al Gurfa Street,

Main market Road,

Tel: 00971-9-2233488

Oman

National Telephone Services Co. LLC
P.O. Box 2786 PC:112, Sultanate of Oman
Tel: +968-709281 Ext. 45/21/75
Fax: +968-791013
E-mail: isonts@omentel.net.om

Qatar

Modern Home,
51-East - Salwa Road,
Al-Maha Complex, Doha
Tel: 00974-4257844 / 00974-4257777
Fax: 00974-4314700

Bahrain

Authorized Service Center,
Bldg: 211, Rd: 339, Block: 321,
Old Place Road, Manama,
Tel: 00973-17311173
E-mail: servicemanager@ashrafs.com.bh

Saudi Arabian Service Centers:

Ahmed Abdulwahed Trading Co.

Jeddah Service Center

Al-Amal Plaza, Hail Street,
Jeddeh, Saudi Arabia,
Tel: 02-6500282 Ext. 209

Riyadh Service Center

Olaya Street
Riyadh, Saudi Arabia,
Tel: 01-4622470 / 4623850

Khobar Service Centre

Al-Khobar Street,
Al-Khobar, Saudi Arabia,
Tel: 03-8944193/03-8952359

Madina Munawara

Al-Ayon Street,
Tel: 00966-4-8387931

Khamis Mushyat

Al-Khalidiya St.,
Tel: 00966-7-2230772

Tabuk

Main Street,
Tel: 00966-4-4219232

Kuwait

Customer Service Hotline Kuwait

Tel: 00965-22458737 / 00965-22458738
Al-Baptain Service Center
Shop #: 247
Qibla, Block 11,
Avenue 11,
Souk al Kabeer,
Fahad Al Salem Street,
Tel: 00965-2464993

Jordan

SEDR Home & office Electronics
Co - Tronicom
Wasfi Al-Tal St.,
Building No. 80,
2nd floor,
Tel: 00962-6-5625460/1/2

Lebanon

306, Jdeideh Sin el Fil Blvd,
Tel: 00961-1240259 / 00961-1236110

Protecting our environment

Our environmental statement

We at Gigaset Communications GmbH are aware of our social responsibility. That's why we actively take steps to create a better world. In all areas of our business - from product planning and production to sales and waste disposal - following our environmental conscience in everything we do is of utmost importance to us.

Learn more about our earth-friendly products and processes online at gigaset.com
www.gigaset.com.



Gigaset Communications GmbH is certified pursuant to the international standards EN 14001 and ISO 9001.

ISO 14001 (Environment): certified since September 2007 by TÜV SÜD Management Service GmbH.

ISO 9001 (Quality): certified since 17/02/1994 by TÜV SÜD Management Service GmbH.

ECO DECT

Make your contribution towards protecting the environment with your Gigaset.

Reducing electricity consumption

An electricity-saving plug connector means your device uses less electricity.

Reducing radiation (dependent on base)

It is only possible to reduce radiation when your Gigaset base also supports this function. The radiation from the Gigaset L410 is **automatically** reduced, depending on the distance from the base. In addition, the Gigaset L410 supports the **Eco Mode/Eco Mode+** functions on Gigaset bases. For more information, please read the instructions for your base.

Disposal



Batteries should not be disposed of in general household waste. Observe the local waste disposal regulations, details of which can be obtained from your local authority.

All electrical and electronic equipment must be disposed of separately from general household waste using the sites designated by local authorities.

If a product displays this symbol of a crossed-out rubbish bin, the product is subject to European Directive 2002/96/EC.

The appropriate disposal and separate collection of used equipment serve to prevent potential harm to the environment and to health. They are a prerequisite for the re-use and recycling of used electrical and electronic equipment.

For further information on disposing of your used equipment, please contact your local authority or your refuse collection service.



Disposing of the batteries

Note: Your device uses a battery that is subject to EU Directive 2006/66/EC and national legal regulations based thereon. The device and the battery contained therein may not be disposed of in unsorted household waste; they must be disposed of at a facility for separate collection of waste.

The battery can be removed easily, as shown in the diagram (page 4)

Appendix

Care

Wipe the unit with a **damp cloth** or an **antistatic cloth**. Do not use solvents or microfibre cloths. **Never** use a dry cloth. This can cause static.

Contact with liquid

If the device comes into contact with liquid:

- 1** **Switch off the device and immediately remove the battery pack .**
- 2** Allow the liquid to drain from the device.
- 3** Pat all parts dry. Place the device in a dry, warm place **for at least 72 hours (not in a microwave, oven etc.)**.
- 4** Do not switch on the device again until it is completely dry.

When it has fully dried out, you will normally be able to use it again.

In rare cases, contact with chemical substances can cause changes to the telephone's exterior. Due to the wide variety of chemical products available on the market, it was not possible to test all substances.

General specifications

DECT-Standard	Is supported
GAP-Standard	Is supported
Radio frequency range	1880–1900 MHz
Transmission power	10 mW, average power per channel 250 mW, pulse power
Repetition frequency of the transmission pulse	100 Hz
Duration of the transmission pulse	370 µs
Environmental conditions for operation	+5°C to +45°C, 20% to 75% relative humidity
Size and weight	79 x 36 x 20 mm (H x B x D), approx. 30 g (including battery)
Standby time	max. 120 hours
Talk time	max. 5 hours
Charging time	max. 2.5 hours
Range	up to 300 m outdoors, up to 50 m indoors
Power supply	230 V, ~50 Hz
Power consumption	1.3 W when charging, 0.05 W when charged

Recommended batteries

Li-Polymer (re-chargeable), 240 mAh, part number: Gigaset V30145-K1310-X448

Compatibility

Depending on your cordless DECT telephone, the following functions may be supported:

Function	Telephone	Gigaset C610/C610A, S810/ S810A, SL400/SL400A *	Other Gigaset telephones/GAP telephones from other manufacturers	ISDN and IP-telephones
Accept call on Gigaset L410	yes	yes	yes	yes
Transfer call to Gigaset L410	yes	yes	yes	yes
One-click switch between handset and Gigaset L410	yes	no	no	no
Join conference call/take over call	yes**	yes**	no	no
Include Gigaset L410 in a conference call	yes	yes	yes	yes
* see also www.gigaset.com/compatibility				
** The "Listening In" function must be available on the telephone and switched on.				

For detailed information on this, please refer to Phoning → page 7.

Note

The list of compatible Gigaset telephones is continuously being expanded. Up-to-date information can be found at www.gigaset.com/compatibility.

Questions and answers

If you have any queries about the use of your telephone, visit our website at www.gigaset.com/customer-care for assistance.

Authorisation

This device is intended for use outside the European Economic Area (excluding Switzerland) depending on national type approval.

Country-specific requirements have been taken into consideration.

We, Gigaset Communications GmbH, declare that this device meets the essential requirements and other relevant regulations laid down in Directive 1999/5/CE.

A copy of the 1999/5/EC Declaration of Conformity is available at this Internet address:

www.gigaset.com/docs

CE 0682

Issued by
Gigaset Communications GmbH
Frankenstr. 2a, D-46395 Bocholt

© **Gigaset Communications GmbH 2011**
All rights reserved. Subject to availability.
Rights of modification reserved.
www.gigaset.com

This user guide is made from 100% recycled paper.