

Gigaset S820/S820A – Touch & Type

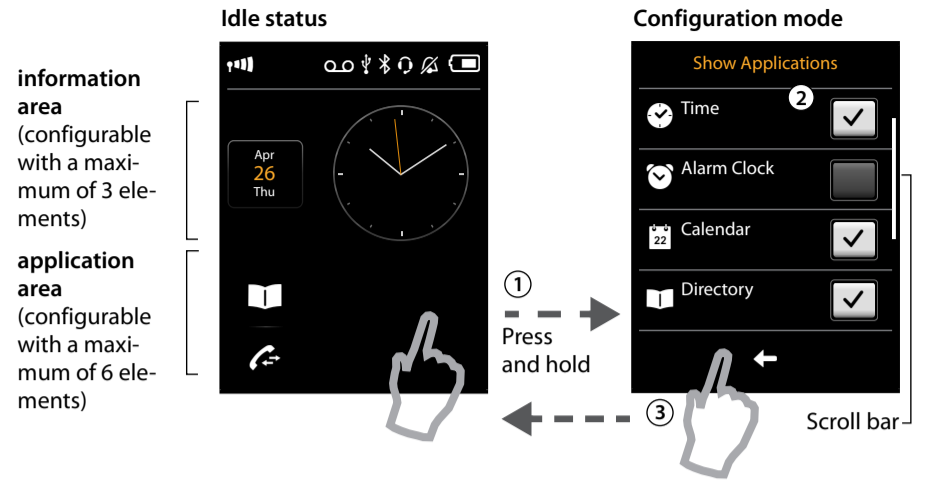

Idle display (individually customisable)

You can customise the idle display to suit your needs. Bring together the key applications you want to start up directly from idle status with a single "touch".



- Switch to configuration mode:**
 Press and **hold** (approx. 2 seconds) any free position on the configurable area on the display.
- Select the desired applications/functions:**
 A selection bar with the available functions/applications is displayed. Scroll through the list to view further entries. To do so, slide your finger vertically over the display while pressing down.
- Return to the idle display:**
 Touch **Back** or briefly touch the end call key **End**. Your selection is saved.

Selectable applications and functions

- | | | |
|---|---|--|
| for the information area | for the application area | |
| <input checked="" type="checkbox"/> Time | <input checked="" type="checkbox"/> Directory | <input checked="" type="checkbox"/> Room Monitor |
| <input checked="" type="checkbox"/> Alarm Clock | <input checked="" type="checkbox"/> Call List | <input checked="" type="checkbox"/> One Touch Call |
| <input checked="" type="checkbox"/> Calendar | <input checked="" type="checkbox"/> Internal Call | |

Menu pages

"Applications"

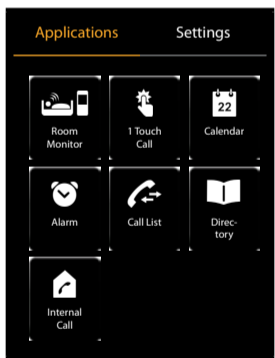

Start telephone applications

"Settings"

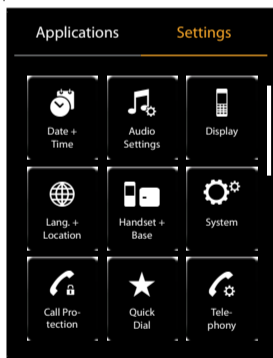

Adapt telephone settings to suit your requirements

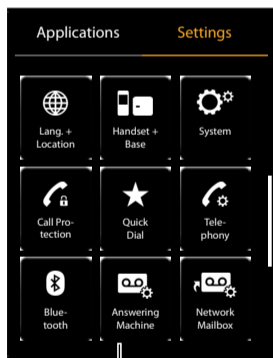

Gigaset S820A only

Switching from the idle display to the Applications menu page and back:

- ▶ Briefly press the **Menu** key.

Switching between menu pages:

- ▶ Touch the desired page in the header.

Go back to the idle display (idle status) from anywhere in the menu:

- ▶ Press the **End** key briefly.

If there are more elements than can be displayed at once:

A scroll bar will appear on the right of the display.

- ▶ Slide vertically over the display while **pressing down** to scroll through the display.

Status bar and status page

The icons in the status bar show the current settings and the operating status of the phone.

Touch the bar to open the status page and change the settings.



To finish, press **Back** or the end call/end key **End**. You are returned to the idle display.

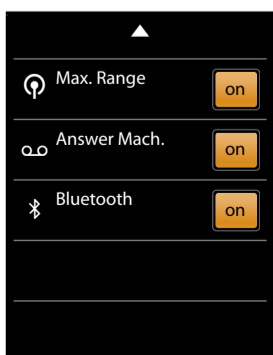

Messages page

You can call up this page by pressing the messages key **Msg** on the keypad.

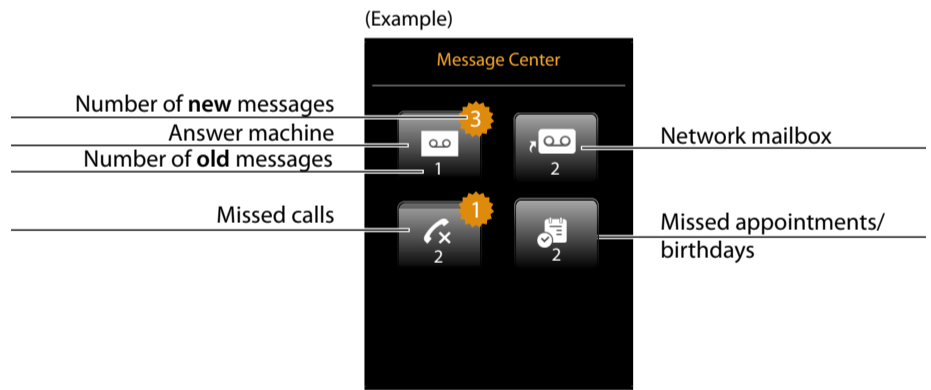

The icon for the network mailbox is always displayed, provided the number is stored in the telephone. The other lists are only displayed if they contain messages.

- ▶ Touch an icon to open the corresponding list.
Exception: If you touch the icon for the **network mailbox**, your telephone will dial the number for the network mailbox. No list will open on the display.

Message pop-up

An advisory tone sounds as soon as a **new entry** arrives in a list. The message key will also flash (if activated). The message pop-up is displayed and partially covers the idle display.

The number of new messages in each list is displayed beneath the icons.

- ▶ **Close the pop-up:** Touch **Close** (top right).
- ▶ **Open the list:** Touch the relevant list icon.
 If the network mailbox has been configured:
 Touching **Msg** opens the message page rather than a list.

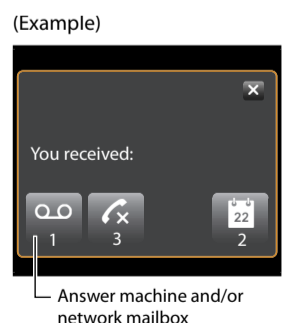

Issued by
 Gigaset Communications GmbH
 Frankenstrasse 2a, 46395 Bocholt,
 Germany

© Gigaset Communications GmbH 2012
 Subject to availability.
 All rights reserved. Rights of modification reserved.
www.gigaset.com

